

LEGENDA

- Area di intervento
- Limite area pubblica/area privata

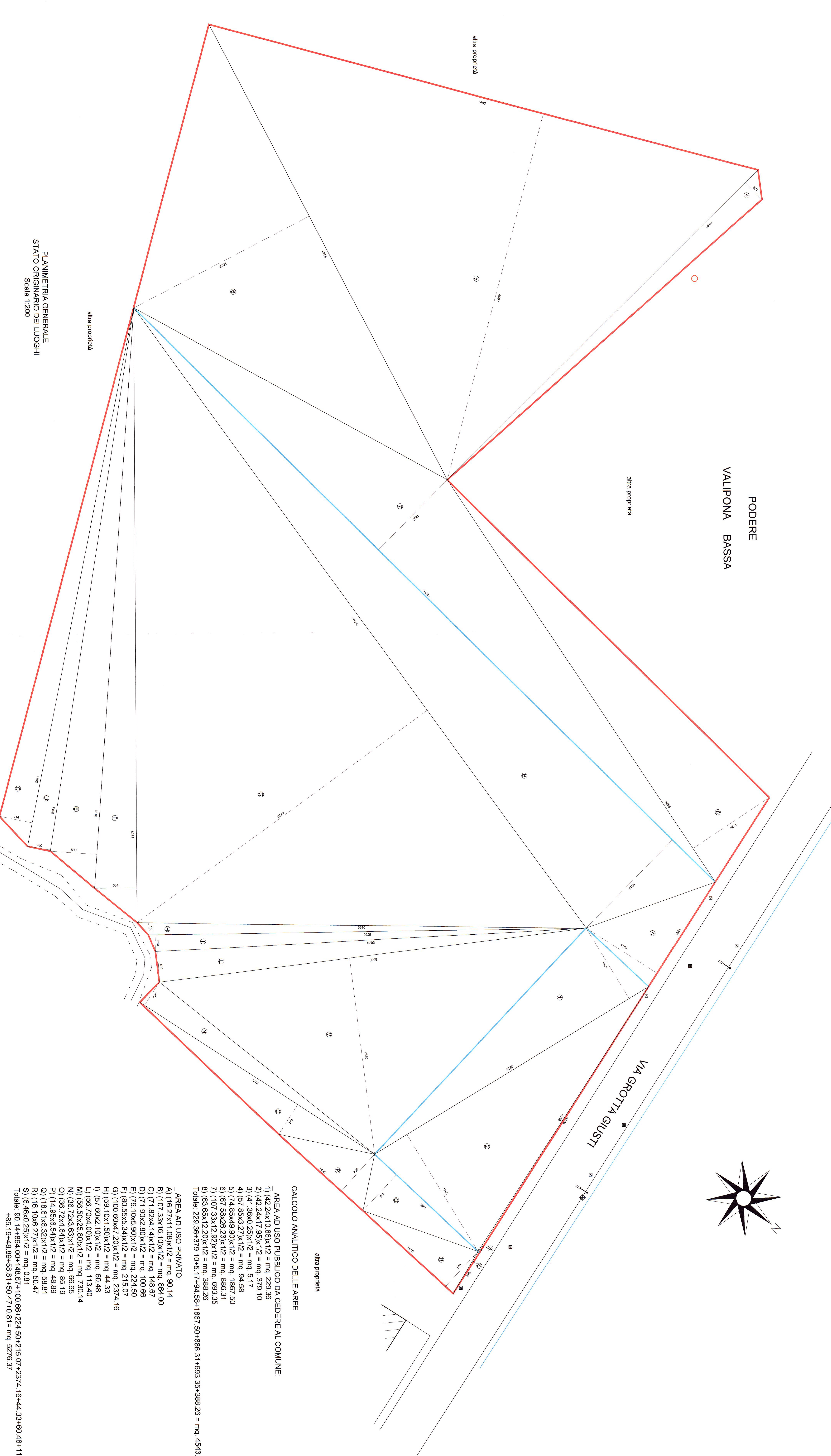

CALCOLO ANALITICO DELLE AREE

AREA AD USO PUBBLICO DA CEDERE AL COMUNE:

- 1) 42,24x17,85x1/2 = mq. 379,10
- 2) 42,24x17,85x1/2 = mq. 379,10
- 3) 41,38x0,29x1/2 = mq. 5,17
- 4) 57,88x3,27x1/2 = mq. 94,58
- 5) 74,88x4,90x1/2 = mq. 189,75
- 6) 101,33x4,20x1/2 = mq. 215,07
- 7) 101,33x4,20x1/2 = mq. 215,07
- 8) 63,65x12,20x1/2 = mq. 388,28
- Totale: 229,36+379,10+5,17+94,58+189,75+215,07+215,07+388,28 = mq. 454,63

AREA AD USO PRIVATO:

- A) 16,27x1,08x1/2 = mq. 30,14
- B) 11,07x3x16,10x1/2 = mq. 884,00
- C) 71,82x4,14x1/2 = mq. 148,67
- D) 71,82x4,14x1/2 = mq. 148,67
- E) 10,60x2,50x1/2 = mq. 100,66
- F) 8,60x2,50x1/2 = mq. 107,50
- G) 11,00x6x47,20x1/2 = mq. 2374,16
- H) 59,10x1,50x1/2 = mq. 44,33
- I) 57,60x2,10x1/2 = mq. 60,48
- J) 57,60x2,10x1/2 = mq. 60,48
- L) 56,00x4,90x1/2 = mq. 138,00
- M) 56,00x4,90x1/2 = mq. 138,00
- N) 36,72x4,63x1/2 = mq. 85,65
- O) 36,72x4,63x1/2 = mq. 85,65
- P) 14,85x6,54x1/2 = mq. 48,89
- Q) 14,85x6,54x1/2 = mq. 48,89
- R) 11,00x2,50x1/2 = mq. 50,47
- S) 16,46x0,25x1/2 = mq. 0,81
- Totale: 80,14+884,00+148,67+148,67+100,66+224,50+215,07+2374,16+44,33+60,48+60,48+1113,40+730,14+66,65+48,89+48,89+58,81+50,47+0,81 = mq. 5276,37

TOTALE AREA DI INTERVENTO AL INTERNO DEL P.O.C.C. 454,63+5276,37 = mq. 5820,00

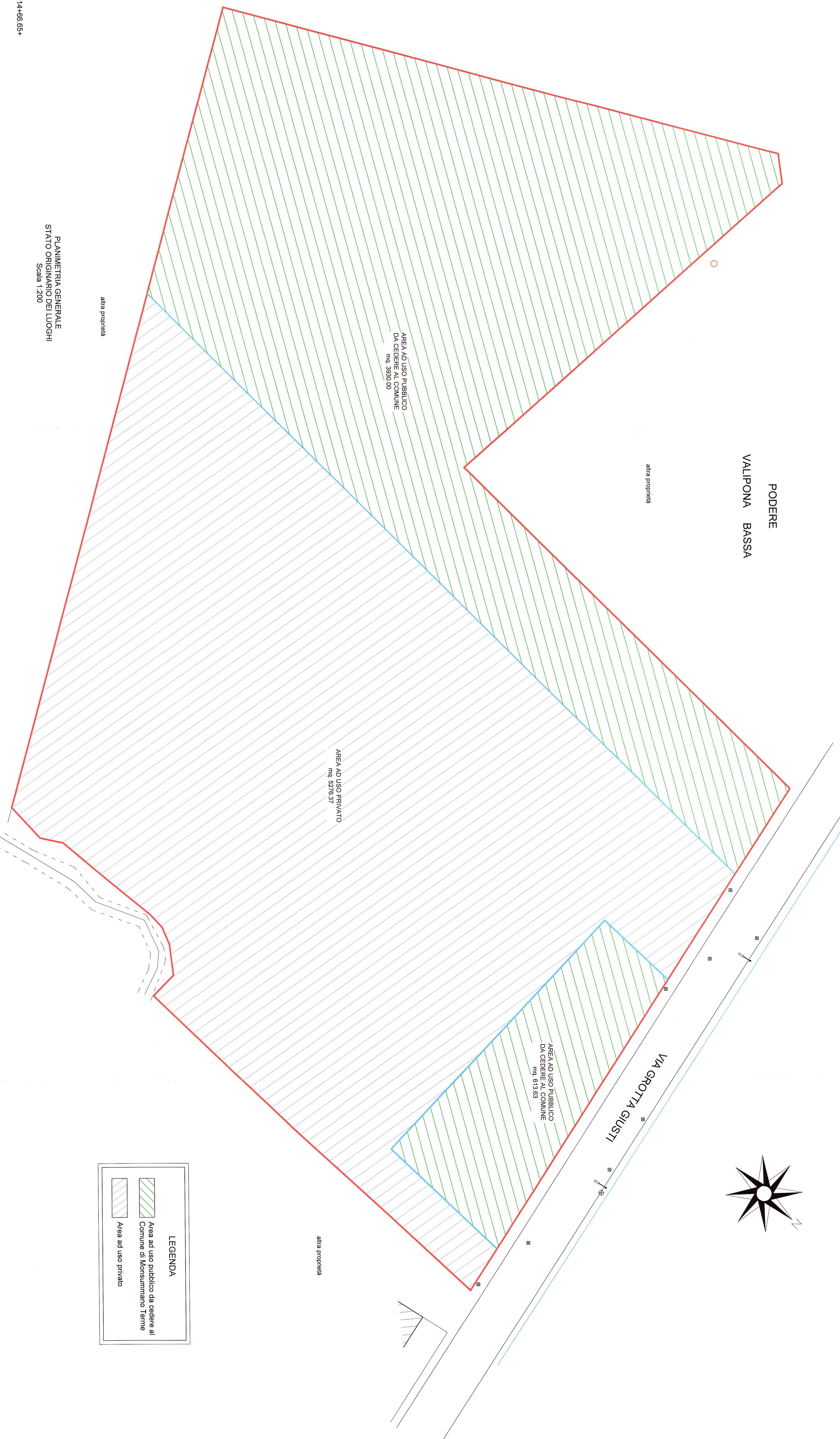

LEGENDA

- Area ad uso pubblico da cedere al Comune di Monsummano Terme
- Area ad uso privato

